

MARK	DESCRIPTION	DATE	APPR.	MARK	DATE	APPR.

DESIGNED BY: P. TOBI	REVISIONS: DATE: AUG 27, 2013	PROJECT NO. / CONTRACT NO.:
CHECKED BY: P. TOBI	LOCATION CODE:	
DRAWN BY: M. WONG	DRAWING NUMBER:	
SUBMITTED BY:	FILE NAME:	
SCALE:	ANSI D:	

U.S. ARMY CORPS OF ENGINEERS HONOLULU DISTRICT FT SHAFTER, HAWAII	CIVIL WORKS TECHNICAL BRANCH CEPO-HEC-T BUILDING 223 FORT SHAFTER, HAWAII	SITE PLAN & SURVEY NOTES
---	--	-----------------------------

FILE: E:\HydroSurvey\Kahului_LDH16\KLO1_VH101\xxxx.dgn
PLOTDRIVER: C:\ProgramData\Bentley\MicroStation V8i (SELECTseries)\WorkSpace\System\plotters\PDF-AEC3.ctb
MIDDLE: SW_Pen.tbl
DATE & TIME: 8/27/2016 12:34:15 PM
LAST SAVED BY: jsc3p3p

KAHULUI NAVIGATION AIDS		
AID NAME	LATITUDE	LONGITUDE
KAHULUI HARBOR "LB 6"	20°53'49.19"	-156°28'29.06"
KAHULUI BOAT RAMP "B 1"	20°53'47.04"	-156°28'32.01"
* KAHULUI BOAT RAMP "B 2"	20°53'47.44"	-156°28'32.31"
KAHULUI BOAT RAMP "B 3"	20°53'45.64"	-156°28'35.51"
KAHULUI BOAT RAMP "B 4"	20°53'44.00"	-156°28'41.59"
KAHULUI BOAT RAMP "B 5"	20°53'44.24"	-156°28'38.71"
* KAHULUI BOAT RAMP "B 6"	20°53'44.74"	-156°28'38.61"
* KAHULUI BOAT RAMP "B 7"	20°53'44.64"	-156°28'41.71"
KAHULUI BOAT RAMP "B 8"	20°53'45.04"	-156°28'40.91"
KAHULUI BOAT RAMP "B 9"	20°53'44.34"	-156°28'43.01"

* BUOY LOCATION INSIDE CHANNEL AREA

FEDERAL PROJECT LINE COORDINATES		
	EASTING	NORTHING
1	1705837.08	204697.65
2	1704992.66	204324.66
3	1704793.17	204336.86
4	1704746.94	204445.47
5	1704654.92	204406.32
6	1704703.47	204292.25
7	1705002.41	204273.97
8	1705857.30	204651.92

PROJECTION: HAWAII STATE PLANE ZONE 2 (FEET)
HORIZONTAL DATUM: NAD83 HARN (1993)
VERTICAL DATUM: LOCAL TIDAL DATUM - (1983-2001)
GEOID: HAWAII 2003

BM NAME	NORTHING	EASTING	H (FT)
AHIU	204593.25	1704804.76	8.20 (LMSL)
* 'IOLE	202242.12	1707122.58	6.89 (LMSL)
* M 10	205148.75	1708865.11	7.25 (LMSL)

(* PLOTS OFF-CHART)

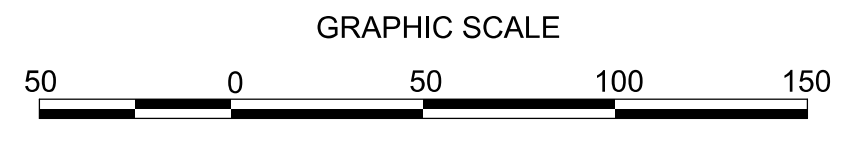

NOTE: ALL UNITS ARE IN U.S. SURVEY FEET (FT)
UNLESS INDICATED OTHERWISE.

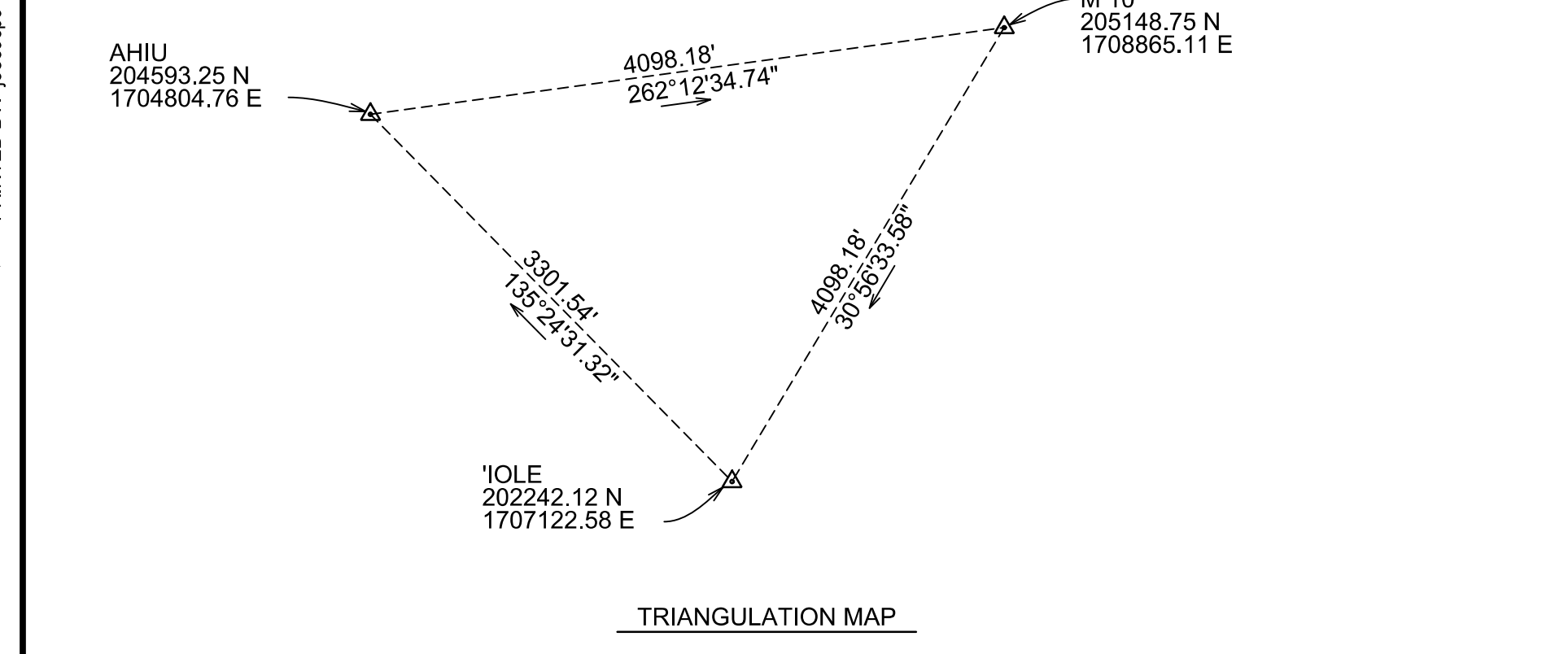

LEGEND

PRIMARY CONTROL POINT: BENCHMARKS: GAGES STAFF: RECORDING:

COORDINATED SURVEY POINT: UNCOORDINATED SURVEY POINTS: DREDGING RANGES FRONT: RIVER MILEAGE FROM MOUTH:

AIDS TO NAVIGATION

LIGHTHOUSES: LIGHTS: LIGHTED RANGES: LIGHTED BUOYS: UNLIGHTED BUOYS: DAYBEACONS: SEASONAL LIGHTS AND LIGHTED DREDGING RANGES:

THE EXISTING PROJECT

PROVIDES FOR AN ENTRANCE CHANNEL 9.5 FEET IN DEPTH AND A TURNING BASIN 8.5 FEET IN DEPTH.

NOTES

APPROXIMATE BANKLINE DIGITIZED FROM PHOTOGRAPHY TAKEN 27 FEB 2015. CONTROL IS BY USACE.

DEPTHS TAKEN FROM HYDROGRAPHIC SURVEY COMPLETED BY U.S. ARMY CORPS OF ENGINEERS, PORTLAND DISTRICT ON 19 JANUARY, 2016.

COORDINATES ARE BASED ON NAD83 HARN (1993) HAWAII STATE PLANE COORDINATE SYSTEM, ZONE 2, SURVEY FEET.

DATUM IS MEAN LOWER LOW WATER.

AZIMUTHS ARE MEASURED FROM SOUTH.

SOUNDINGS ARE SHOWN IN FEET AND INDICATE DEPTHS BELOW MLLW. ELEVATIONS ARE SHOWN THUS: +2, INDICATING HEIGHT IN FEET ABOVE MLLW. THE MLLW PLANE IS SHOWN THUS: THE PROJECT DEPTH CURVE IS SHOWN THUS:

HORIZONTAL DATUM AND LONGITUDE/LATITUDE REFERENCED TO NAD 83 HARN (1993).

GAUGE SITE: 161 5680 C TIDAL, ELEV=5.91 MLLW (1983-2001).

THIS CHART IS INTENDED FOR DREDGING PURPOSES ONLY.

THE INFORMATION DEPICTED ON THIS MAP REPRESENTS THE RESULTS OF SURVEYS MADE ON THE DATES INDICATED AND CAN ONLY BE CONSIDERED AS INDICATING THE GENERAL CONDITION EXISTING AT THAT TIME.